

COUPLINGS, MULTICOUPLINGS & MOULD COOLING PRODUCTS

KUPPLUNGEN, MULTIKUPPLUNGEN & KÜHLUNGSELEMENTE FÜR WERKZEUGE

SERIE 271



NW 4 to 19 mm



Full Flow
Nicht absperrend



Double Shut-off
Beidseitig absperrend

Flachdichtende Wasserkupplung
Flat Face Water Coupling

Options
AISI 316

Pressure - Betriebsdruck
20 bar

Temperature Range - Temperaturbereich :
-25 °C +125 °C / -13 °F +257 °F
With standard seals -
Mit standard Dichtung : Nitrile - NBR (Ni)

Material - Material

Coupler Body - Kupplungsgrundkörper : Brass + Nickel Plated
Sleeve - Hülse : Brass + Nickel Plated
Valve - Ventil : Brass + Nickel Plated
Springs - Federn : Spring Steel
Locking O-Ring-Sprengung :
Balls - Kugeln : AISI 420
Seals - Dichtungen : Nitrile (Ni) - NBR (Ni)
Plug - Nippel : Brass + Nickel Plated
Plug Profile-Steckerprofil :
Valve - Ventil : Brass + Nickel Plated
Spring - Federn : AISI 301 (14310)

**Coupler and Plug
Kupplung und Nippel**

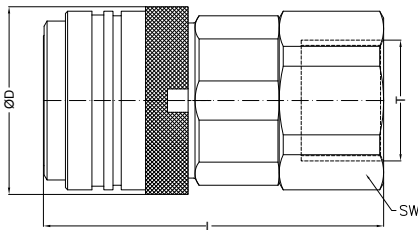

Female Thread Coupler
Kupplung mit Innengewinde

Connection
Anschluß
ØT

Order No - Bestellnr.

Double Shut-off
Beidseitig absperrend



Full Flow
Nicht absperrend

SW

ØD

L

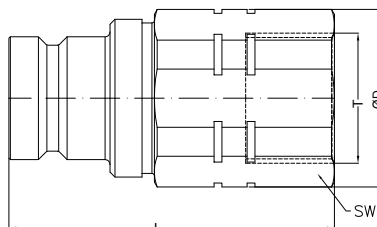
BSP 1/4"	271.04 DGB 13	271.04 DGF 13	19	23	43.5
BSP 3/8"	271.06 DGB 17	271.06 DGF 17	22	29.2	45
BSP 1/2"	271.09 DGB 21	271.09 DGF 21	27	34	59
BSP 3/4"	271.14 DGB 26	271.14 DGF 26	36	41	74.3
BSP 1"	271.19 DGB 33	271.19 DGF 33	46	52	82



Female Thread Plug
Nippel mit Innengewinde

BSP 1/4"	271.04 DUB 13	271.04 DU 13	19	20	47
BSP 3/8"	271.06 DUB 17	271.06 DU 17	22	24	52
BSP 1/2"	271.09 DUB 21	271.09 DU 21	27	29	56.6
BSP 3/4"	271.14 DUB 26	271.14 DU 26	34	36	66
BSP 1"	271.19 DUB 33	271.19 DU 33	41	44	67.6